

ES-Key USM2 Module

WEATHERPROOF VEHICLE MULTIPLEX SYSTEM



USM II (Universal System Manager II) is a solid state module and provides the heartbeat of an ES-Key multiplex system.

The USM II has 6 inputs and 5 outputs. The polarity of the inputs are selectable. It can be used stand-alone or extended as necessary using the full ES-key family of nodes.

Programming is as simple or complex as required. All this is done through a windows graphical user interface - no advanced programming skills required.

With no moving mechanisms and contacts to degrade, solid state controllers offer improved system reliability and faster activation compared to electromechanical equivalents.

KEY FEATURES

- 5 selectable polarity outputs (500mA each)
- 6 selectable polarity inputs
- SAE J1939 CAN engine message link with ES-Key I/O association (high idle, voltage, oil pressure, hand brake)
- Special Programming utilities (timers, counters delays, sequencing, flashes)
- Built-in CAN bus multiplex management
- In built advanced load management functions
- USB port for database transfer and diagnostics
- Master switch capability
- IP67 Watertight
- Fully extendable using the ES-key pro family of modules (see our website)

Antares TDC
Knaves Beech Business Centre
Davies Way
Loudwater
HIGH WYCOMBE
HP10 9QR UK

www.antares.co.uk
email: info@antares.co.uk
tel: +44 (0)1628 535440

ANTARES
engineering with answers

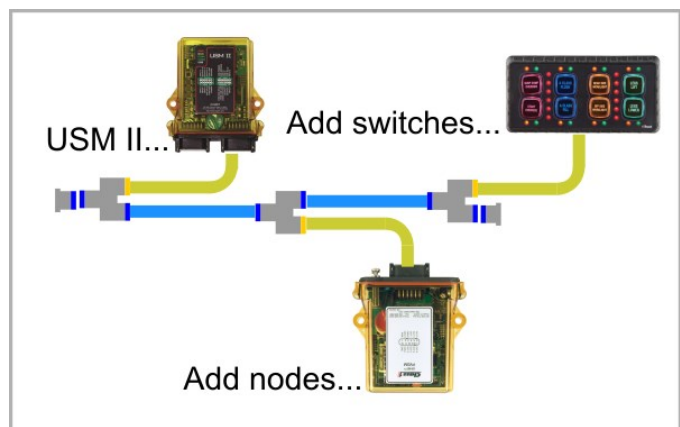

ES-Key USM2 Module

WEATHERPROOF VEHICLE MULTIPLEX SYSTEM

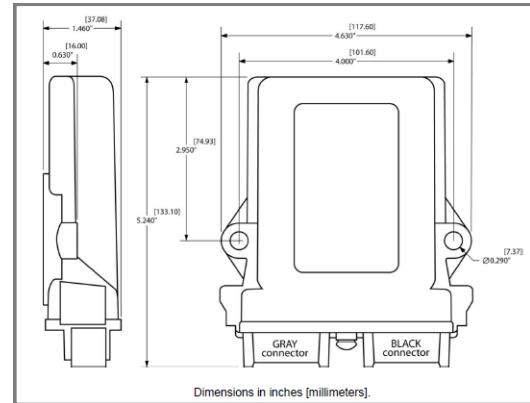
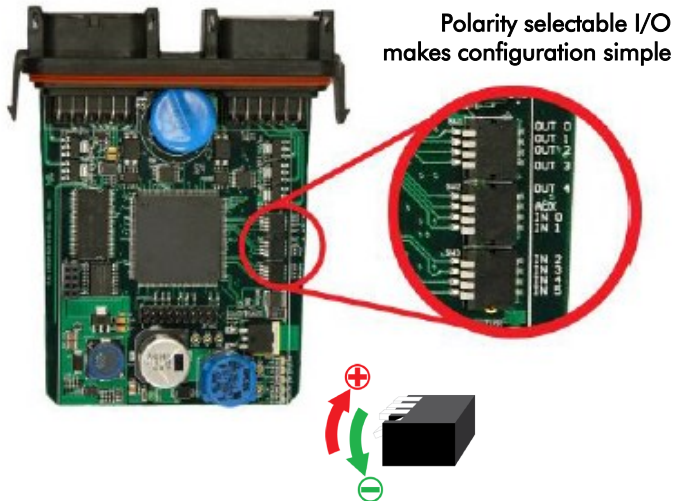

Compact dimensions

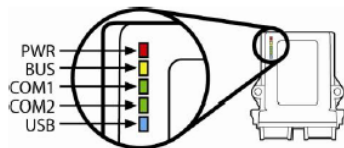

Visual status indication

Technical Details	ES-Key network
Voltage range	+9VDC...+32VDC
Power consumption	Supply + Input: 100mA @13.8VDC 125mA @27.6VDC
Output power	500mA per selectable polarity output
Connections	All outputs are located on the two 12-pin Deutsch connectors Deutsch DT06-12SB BLACK, Deutsch DT06-12SA GREY Mating Sockets: 0462-201-16141 Wedge lock: W12S Recommended wire gage: 16-18 AWG
Temperature range	-40°C...+85°C
Environmental range	IP 67
CAN specification	SAE J1939 standard, 250 Kbits/second
LEDs	2 LEDs for power, 2 LEDs for communication , and 1 LED for USB connectivity.
Protection	<ul style="list-style-type: none"> • Internal thermal fuse (750mA) • Reverse voltage protection • CAN buses protected to 24V • ESD voltage protected to SAE J1113 specification for heavy duty trucks (24V) • Transient voltage protected to SAE J1113 specification for heavy duty trucks (24V) • Load dump voltage protected to SAE J1113 specification for heavy duty trucks (24V) • Outputs protected for short circuit and thermal overload
Dimensions	11.06 (281)]x 2.56 (65)]x 7.31 (186)](W x H x D) In inches [mm]